

Conceptual Storm Sewer Servicing and Storm Management Facilities

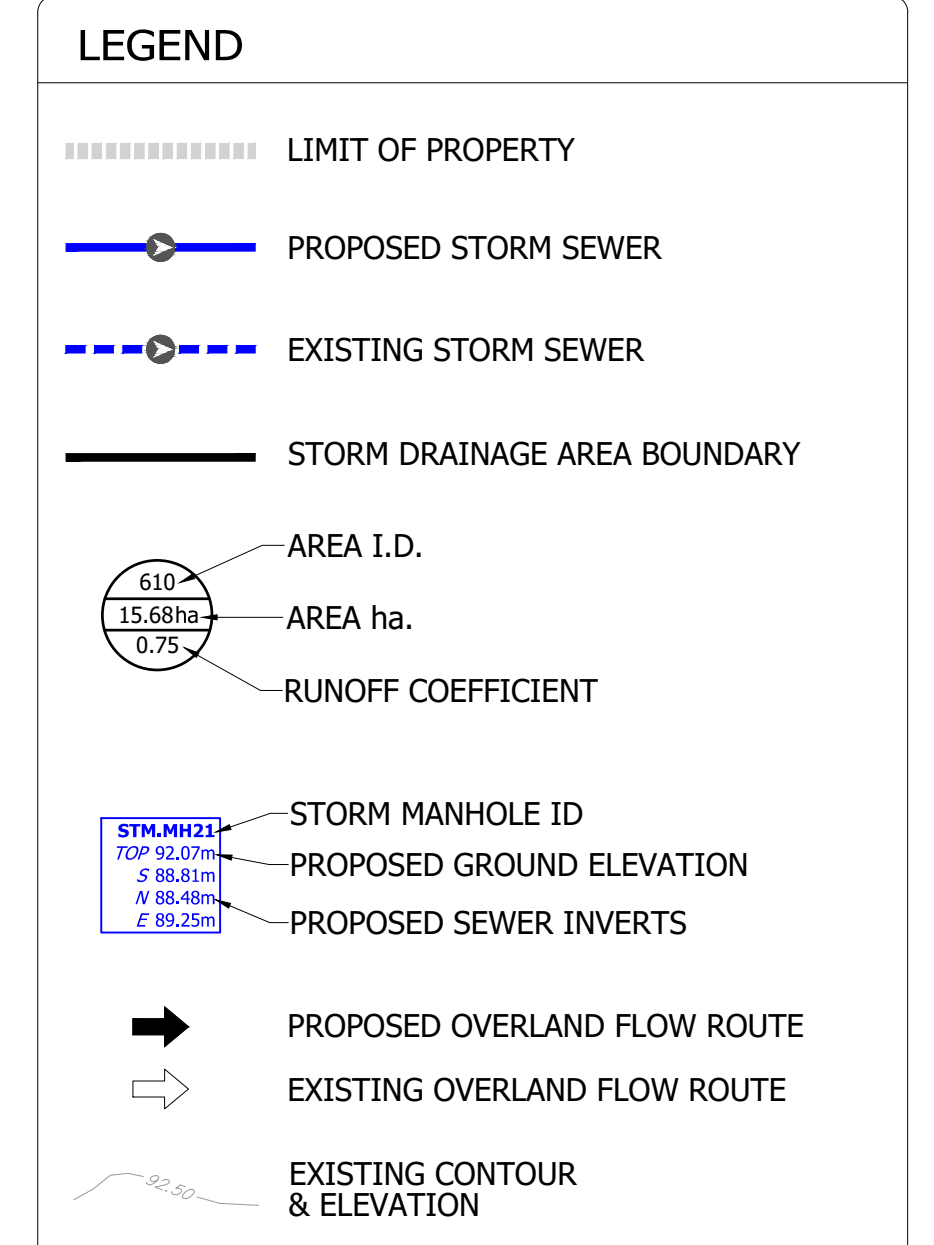
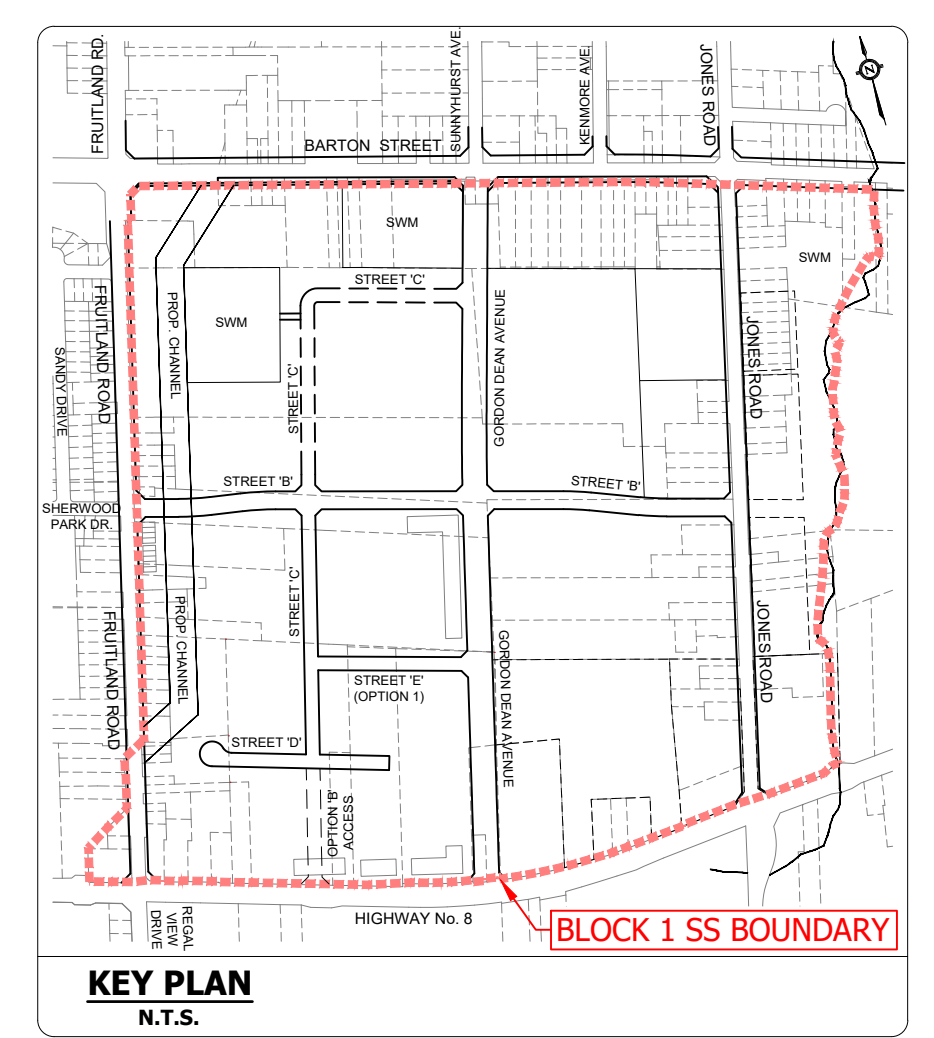
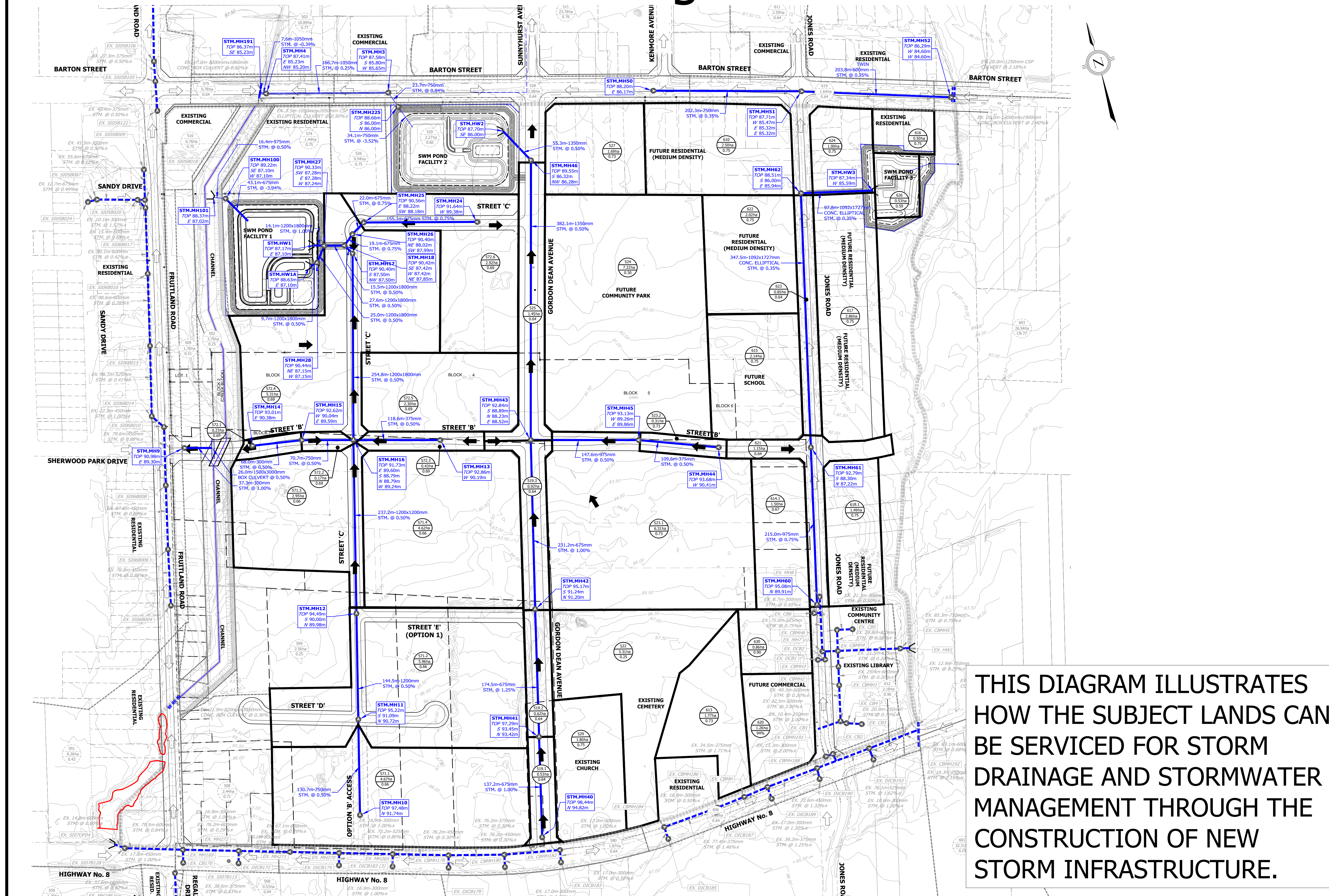

BENCHMARK
MONUMENT # 0772020001
ROUND IRON BAR WITH BRASS CAP LOCATED IN STONEY CREEK 9m NORTH OF CENTRELINE OF BARTON STREET 5m WEST OF CENTRELINE OF SUNNYHURST AVENUE AND 4m EAST OF CENTRELINE OF DRIVEWAY TO HOUSE NO. 713.
ELEVATION: 87.489m CGVD-1928-1978.

URBANTECH®
URBANTECH® Consulting
A Division of Leighton-Zec West Ltd.
2030 Bristol Circle, Suite 105
Oakville, ON, L6H 0H2
TEL 905.829.8818 • urbantech.com

BLOCK 1 SERVICING STRATEGY
CITY OF HAMILTON

CONCEPTUAL STORM SEWER SERVICING

PROJECT No.	DATE	SCALE	DWG No.
20-263	SEPT. 2023	1:2500	PIC-12

F:\PROJECTS\20-263\BLOCK1-SS\HAMILTON\DRAWINGS\20-263-PIC-12.DWG

THIS DIAGRAM ILLUSTRATES HOW THE SUBJECT LANDS CAN BE SERVICED FOR STORM DRAINAGE AND STORMWATER MANAGEMENT THROUGH THE CONSTRUCTION OF NEW STORM INFRASTRUCTURE.